



3/57 Maude Street Belmont, NSW



2



1



1

Handy central location for over 55's

** Conditions of entry photo ID & a face mask is recommended **

Centrally located in Belmont, this quiet, single-level home in a small complex for the over 55's, is neat and tidy and offers maximum convenience in terms of proximity to shops, cafes, doctors, bus routes and the lake foreshore.

- Located 100m from the lake and less than 300m from Belmont Citi Centre
- At the rear of the complex away from traffic noise and with lock up garage a few steps away from the door
- Good sized kitchen and lounge/dining with split system air conditioning
- Combined bathroom/laundry with plenty of storage, separate toilet

The perfect easy-care home for a retired single or couple who want to be close to the lake

Council Rates: \$344.10 p/q

Strata Rates: \$473.80 p/q

One Agency Eastlakes -

Swansea

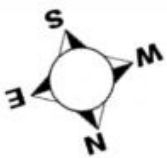
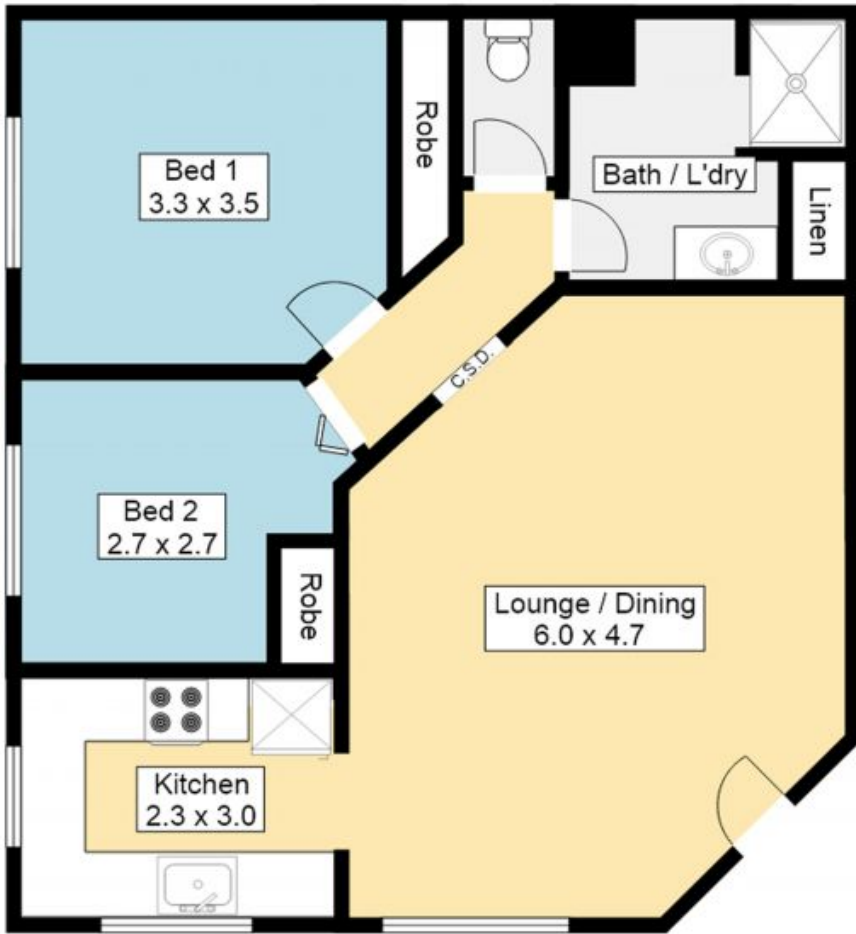

Floor Plan Disclaimer: Whilst care has been taken, all measurements are approximate and intended as a guide only. Any person using this information other than as a guide should always rely on their own enquiries.

3/57 Maude Street, Belmont

ONE AGENCY
EASTLAKES