



16/319 Old Pacific Highway Swansea NSW

2 1 1

Presenting an immaculately presented Villa in the ever-desirable Parbury Gardens community. Unit 16, with its elevated positioning and leafy outlooks, stands as a great opportunity for the first-home buyer, down-sizer or savvy investor. A solid brick-and-tile construction and low strata fees make this a brilliant opportunity to move in and enjoy.

This wonderful Villa has all the bells and whistles you could ever need; air-conditioning, modern appliances, dishwasher - its all here. Sleek, modern vinyl planks throughout elevate the space; working well with the flowing layout and abundance of natural light.

Key property features

- Two bedrooms, both with built-in wardrobes
- Bathroom with separate toilet

Price : \$ 625,000

View : <https://www.oneagencyeastlakes.com.au/7600849>



Tony Rich
02 4971 6000

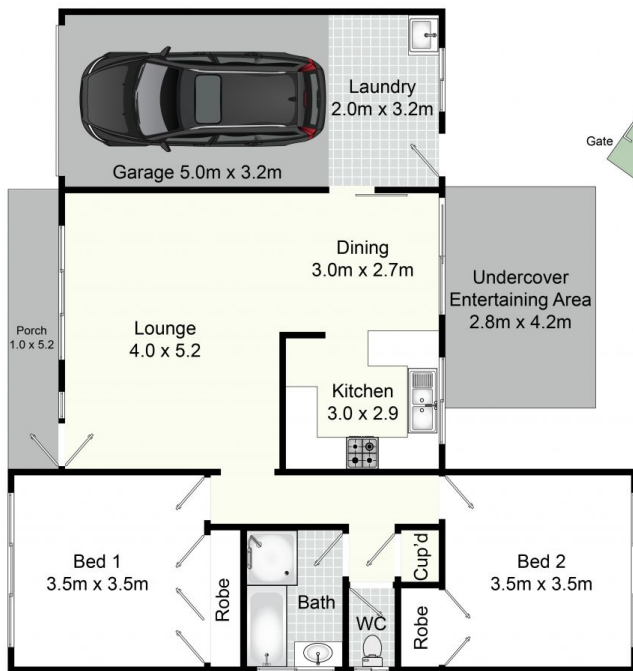

GROUND FLOOR



SITE PLAN

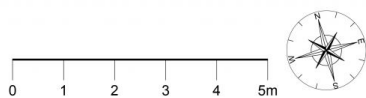

16/319 Old Pacific Highway, Swansea